

Rectifier Manifold

SAE ORB Ports

MATL: STEEL

CARTRIDGES: STD (STANDARD), COMPACT, PARKER, SUN, AND VICKERS (OR EQUIVALENT)

'1' IS NOSE OF CARTRIDGE

NOTE: COMPACT CP12-2 CAVITY EQUIVALENT TO HYDRAFORCE VC12-2 CAVITY
AND PARKER C12-2 CAVITY IS EQUIVALENT TO OILGEAR HS800-2 CAVITY

CONSULT CARTRIDGE MANUFACTURER FOR RATED PRESSURE, FLOW RATE AND CAVITY DETAIL.

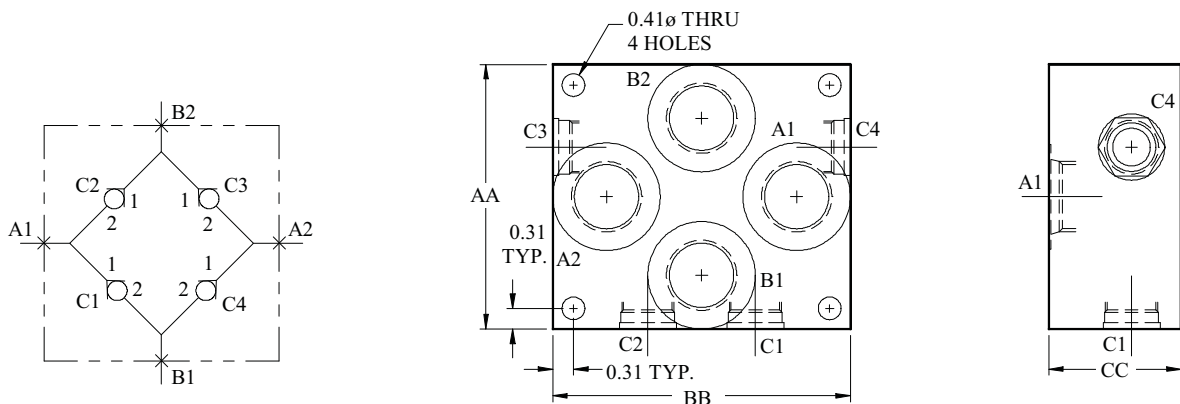

Part No.	C Cavity	A1, A2, B1, B2 SAE ORB	AA	BB	CC
MB2274S	STD C-10-2	#12 (1 1/16-12)	4.00	4.50	2.00
MB2275S	COMPACT CP12-2	#16 (1 5/16-12)	5.00	5.00	2.00
MB2276S	VICKERS C-12-2	#16 (1 5/16-12)	5.00	5.00	2.00
MB2277S	PARKER C12-2	#16 (1 5/16-12)	5.00	5.00	2.00
MB2278S	STD C-16-2	#20 (1 5/8-12)	6.00	6.00	2.50
MB2279S	STD C-20-2	#24 (1 7/8-12)	7.25	7.75	3.00
MB2280S	SUN T-13A	#12 (1 1/16-12)	4.00	4.50	2.00
MB2281S	SUN T-5A	#16 (1 5/16-12)	5.00	5.00	2.00
MB2282S	SUN T-16A	#20 (1 5/8-12)	6.00	6.75	2.50
MB2283S	SUN T-18A	#24 (1 7/8-12)	8.25	8.50	3.00